

Modular Panel Jack, RJ45K (8x8K) / Wires, 30μ

Features for this product

- Panel mount RJ11/12 and RJ45 jacks with 10" wire leads for voice or data applications
- Flange mount design accepts #4 or #5 screws for secure panel mounting
- 30 microinches gold plating for a durable connection
- UL94V-0 rated ivory plastic shell for ruggedness
- 10" wire leads allow connection directly to a PC board



L-com's exclusive line of panel mount jacks is the perfect choice for passing modular cables through a rack panel or wall plate. The unique flange mount design accepts #4 or #5 screws for secure mounting of these couplers to any panel (purchased separately). Contacts have 30 microinches of gold plating for durability and the ivory plastic shell is UL94V-0 rated. 10" wire leads allow you to connect directly to a PC board or another connector. These couplers can be used for either voice or data applications. Large volume discounts offered; Call today.

Details for this Modular product

L-com Item #	ECJ504-8
Manufacturer	L-com
UPC #	822335022799
RoHS Status	RoHS Compliant 
Color	Ivory

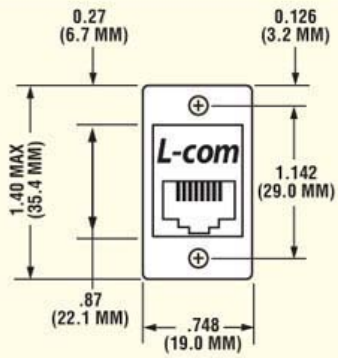

ECF & ECJ Front View

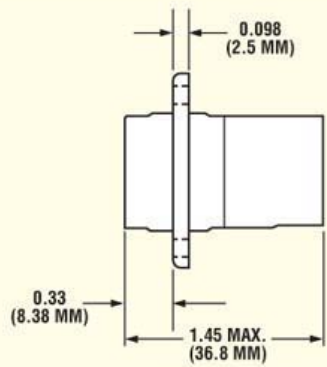

ECF Side View

USB Style Connectors

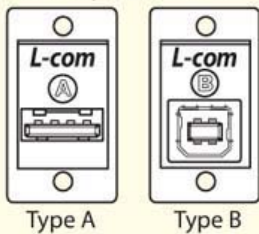

USB Type A & B

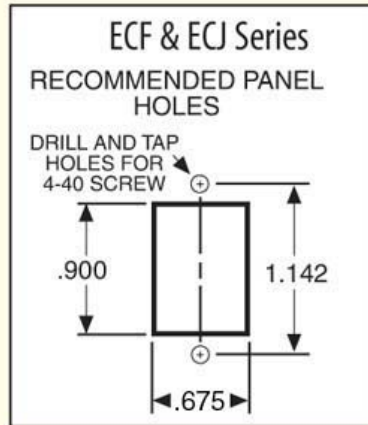

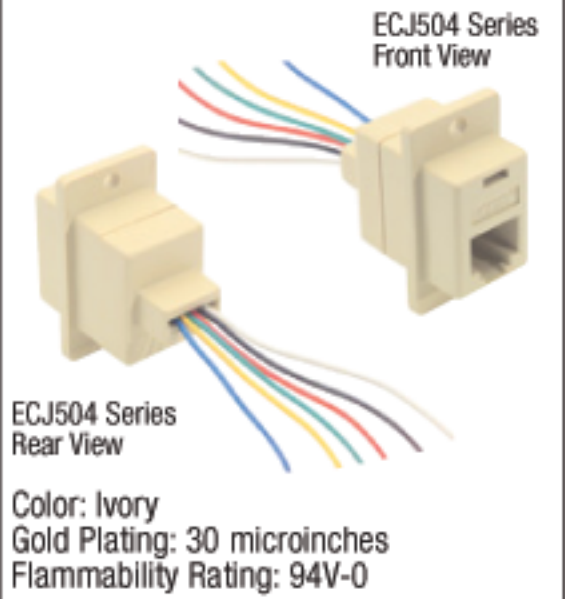
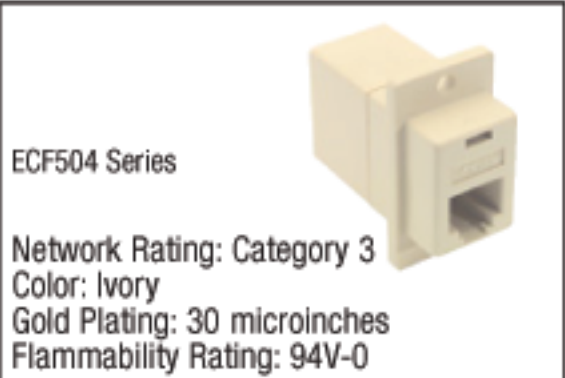

Item #	Description	Color
Deluxe Panel Mounted Modular Couplers, 30 Microinches Gold, Ivory Color		
These straight and cross wired modular couplers are available exclusively from L-com. Eight different configurations all fit into the same 0.675 x 0.900 inch rectangular opening. Wire contacts have 30 microinch gold plating for multiple insertions. Plastic is 94V-0 rated. Color: Ivory. Flange accepts #4 or #5 mounting screws to be purchased separately. Category 3 rated.		
ECF504-4C	Modular Coupler, RJ11 (6x4), Crossed, 30µ	Ivory
ECF504-6C	Modular Coupler, RJ12 (6x6), Crossed, 30µ	Ivory
ECF504-6CMJ	Modular Coupler, MMJ (6x6), Crossed, 30µ	Ivory
ECF504-8C	Modular Coupler, RJ45 (8x8), Crossed, 30µ	Ivory
ECF504-4S	Modular Coupler, RJ11 (6x4), Straight, 30µ	Ivory
ECF504-6S	Modular Coupler, RJ12 (6x6), Straight, 30µ	Ivory
ECF504-6SMJ	Modular Coupler, MMJ (6x6), Straight, 30µ	Ivory
ECF504-8SK	Modular Coupler, RJ45 (8x8K), Straight, 30µ	Ivory
ECF440	Machine Screws, 4-40 x 5/16", Pkg/100	

Deluxe Panel Mounted Modular Jacks - 10" Wire Leads, 30 Microinches Gold, Ivory Color		
One difficulty in using modular jacks is the mounting problem on a panel. L-com's solution to this problem is providing a flange that mounts with two screws in a 0.675" x 0.900" rectangular opening. Choice of RJ11/12 (6x6) or RJ45 (8x8K) usable with keyed or non-keyed plugs. Custom versions of other jack types considered in quantities of 500/up. Mounting screws must be purchased separately.		
ECJ504-6	Modular Panel Jack, RJ12 (6x6) / Wires, 30µ	Ivory
ECJ504-8	Modular Panel Jack, RJ45K (8x8K), / Wires, 30µ	Ivory
ECF440	Machine Screws, 4-40 x 5/16", Pkg/100	

Deluxe Panel Mounted Couplers, 50 Microinches Gold, Black Color		
These couplers are similar to the ECF504 Series with two changes. The molding has been changed to a Black color for applications when Ivory is not wanted. Also, the contacts have 50 microinches of gold for superior mating with modular plugs. Mounting screws must be purchased separately. Category 3 rated.		
ECF504B-4S	Modular Coupler, RJ11 (6x4), Straight, 50µ	Black
ECF504B-6S	Modular Coupler, RJ12 (6x6), Straight, 50µ	Black
ECF504B-8SK	Modular Coupler, RJ45K (8x8K), Straight, 50µ	Black
ECF440	Machine Screws, 4-40 x 5/16", Pkg/100	

19" Patch Panels - Equipped with 16 or 32 ECF504 Series Modular Couplers		
These 19" patch panels utilize the ECF504 series couplers. For your convenience, two panel heights are offered; 1.75" with 16 modular adapters or 3.5" with 32 modular adapters. Panel legend is 1-16 or 1-32. Color: Bone. Available with straight-thru wiring.		
PR175F504-6S	1.75" 16 Port Panel RJ12 (6x6), Straight-Thru	Bone
PR175F504-8SK	1.75" 16 Port Panel RJ45 (8x8), Straight, Keyed	Bone
PR35F504-6S	3.50" 32 Port Panel RJ12 (6x6), Straight-Thru	Bone
PR35F504-8SK	3.50" 32 Port Panel RJ45 (8x8), Straight, Keyed	Bone

19" Modular Patch Panels - Equipped with 16 or 32 ECF504B Modular Couplers		
These panels utilize the ECF504B couplers with 50 microinch plating. 16 and 32 port available. Straight thru pinned only. Color: Black.		
PR175F504B-4S	1.75" 16 Port Panel RJ11 (6x4), Straight-Thru	Black
PR175F504B-6S	1.75" 16 Port Panel RJ12 (6x6), Straight-Thru	Black
PR175F504B-8SK	1.75" 16 Port Panel RJ45 (8x8), Straight, Keyed	Black
PR35F504B-4S	3.50" 32 Port Panel RJ11 (6x4), Straight-Thru	Black
PR35F504B-6S	3.50" 32 Port Panel RJ12 (6x6), Straight-Thru	Black
PR35F504B-8SK	3.50" 32 Port Panel RJ45 (8x8), Straight, Keyed	Black

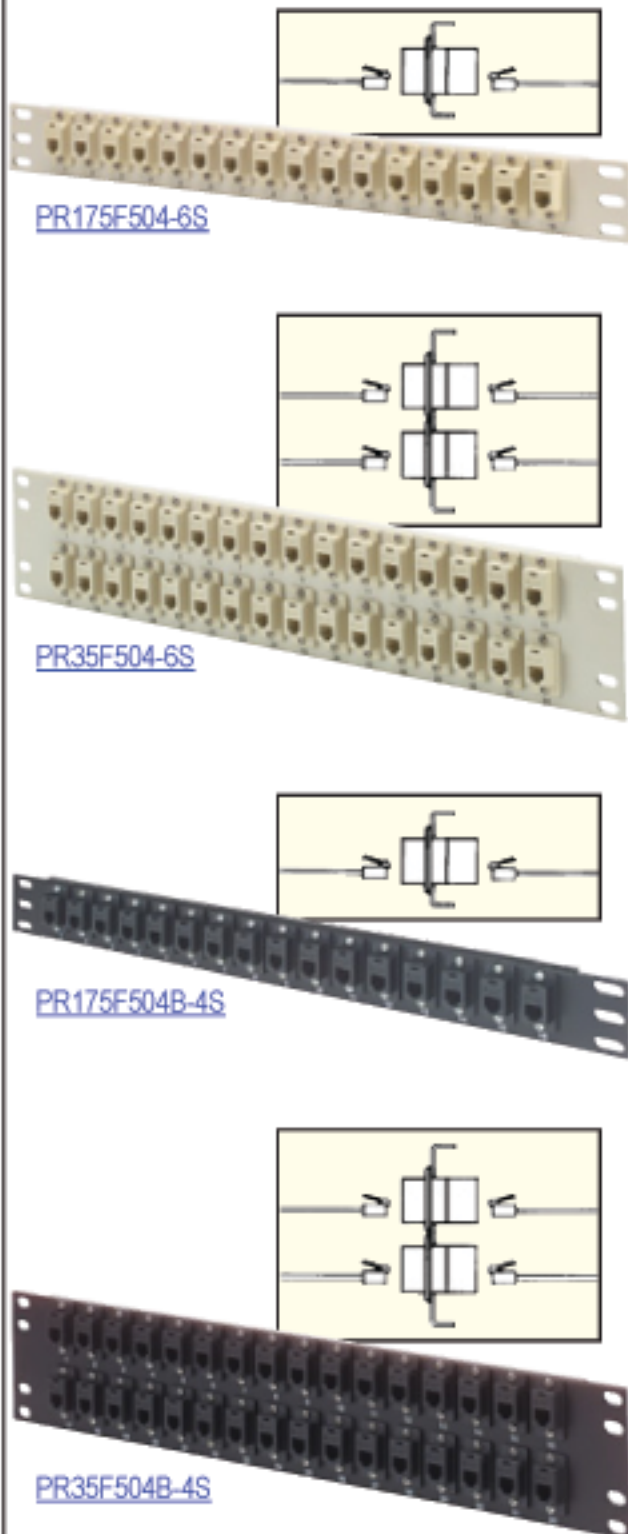

How Rack Spaces and Sizes are Measured

1 Rack Space = 1.75 inches

2 Rack Spaces = 3.5 inches

Racks are a great way to neaten up wiring closets and labs. Network equipment and rack panels usually come in 1.75", 3.5" and 5.25" heights. (1, 2 and 3 rack spaces).